



## INSTALLATION INSTRUCTIONS

Your Rupp Marine Z-30 Top Guns come fully assembled. To install, you will need a 1/4" allen wrench, a 9/16" wrench or adjustable wrench.

Please contact us at 772-286-5300 or at [service@ruppmarine.com](mailto:service@ruppmarine.com) with any questions.

rev. 041603

**1**

Removing the bolt from the Radial Handle using the 9/16" wrench or adjustable wrench.

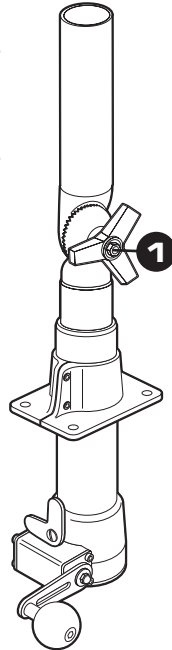

**2**

Disassemble Radial Arm from Z-30 Top Gun by removing Radial Handle.

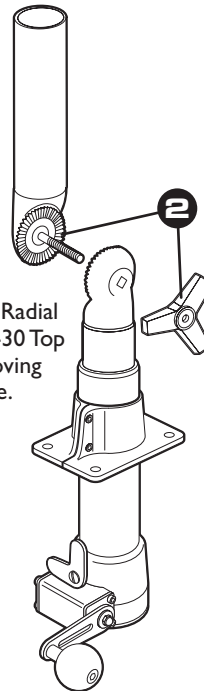

**3**

Loosen Mounting Collar by unscrewing both allen screws with allen wrench.

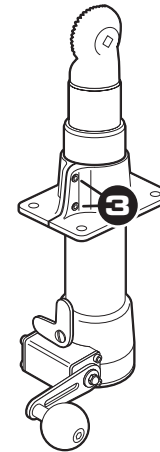

**4**

Slide Mounting Collar vertically to remove from Z-30 Top Gun.

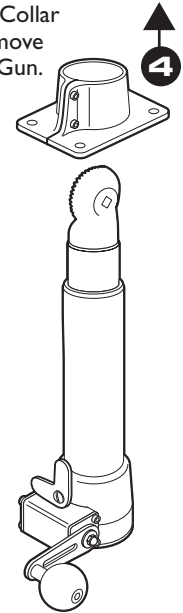

**5**

Attach Mounting Collar to Mounting Plate with 5/16" stainless steel allen bolts and washers. DO NOT FULLY TIGHTEN BOLTS.

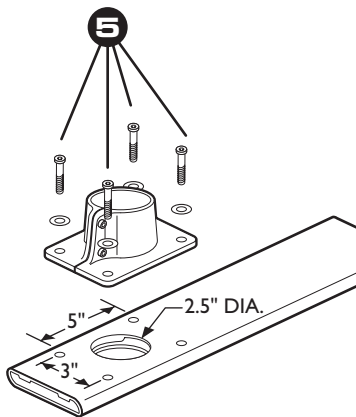

Note: Bolts are provided for use with the Z-30 Mounting Plate. Other installations may require different fasteners.

**6**

Insert Z-30 into Mounting Collar from underneath.

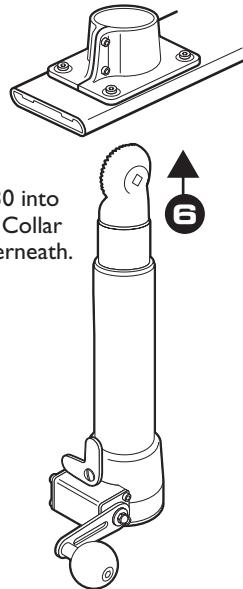

**7**

With Z-30 in desired position, tighten both allen bolts with allen wrench to secure the Z-30. TIGHTEN BOLTS TO SECURE COLLAR TO PLATE.

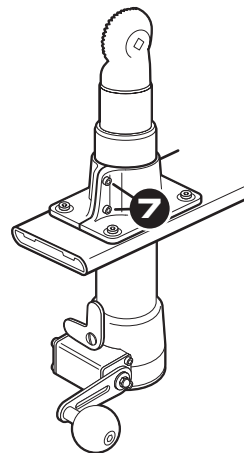

**8**

Insert bolt of Radial Arm into hole of Z-30. Secure Radial Arm to Z-30 by attaching Radial Handle to bolt on Radial Arm.

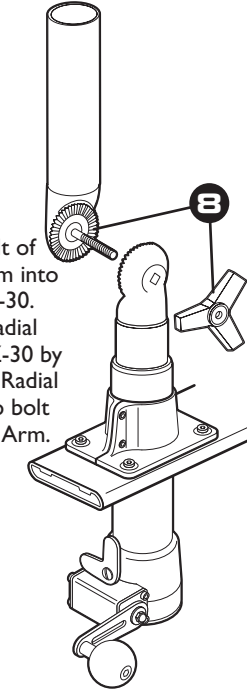

**9**

Secure entire Z-30 assembly by tightening nut to Radial Handle with wrench until the bolt slightly protrudes.

The Z-30 Handle is adjustable for precise alignment. Just remove Cap Nut, remove and rotate Handle to desired position. Replace Handle and secure with Cap Nut.

