



RUPP MARINE, INC.
Anchor Ave
P.O. Drawer F
Port Salerno, FL 34992
Ph # 772-286-5300

CLASSIC TOP GUNS Weld-In Series

Instructions for Installing

1. TOP GUNS are welded directly into your aluminum top.

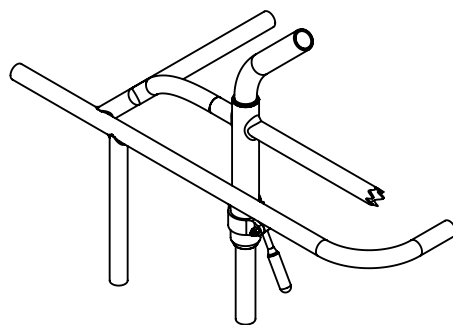

FIG. 1

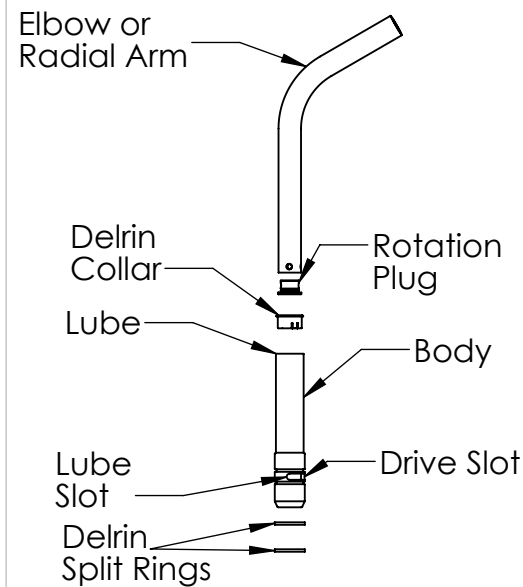
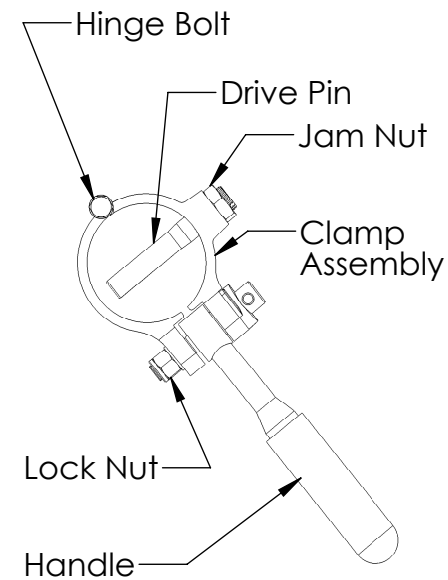

FIG. 2



Clamp Assembly
FIG. 2A

2. Study parts of TOP GUN before installing.

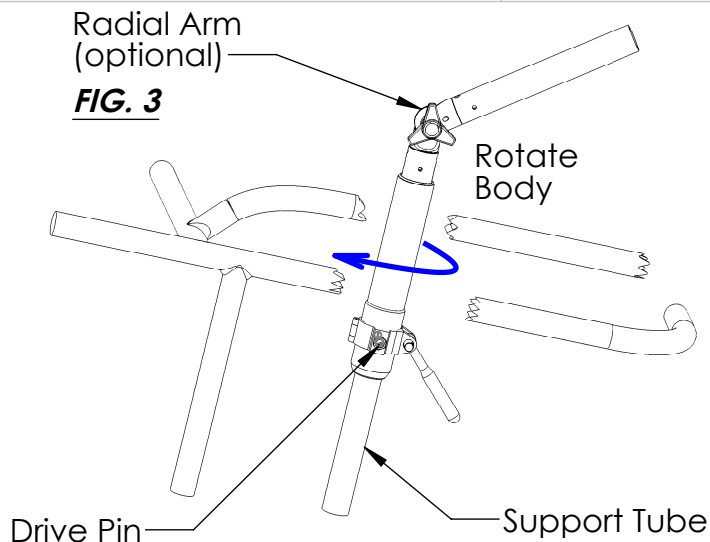

FIG. 3

3. Place assembled TOP GUN on support tube. Elbow should be in line with handle. Move handle to straight back position so the elbow and handle are pointing directly aft. Rotate body, keeping handle stationary, until drive pin stops body from moving further.

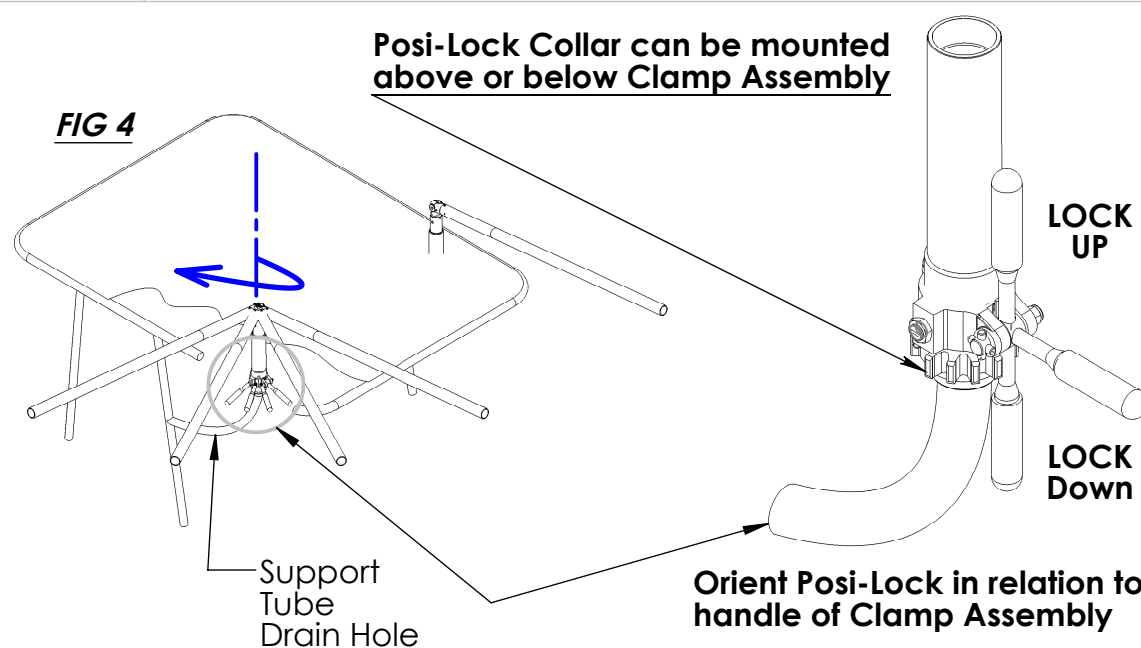
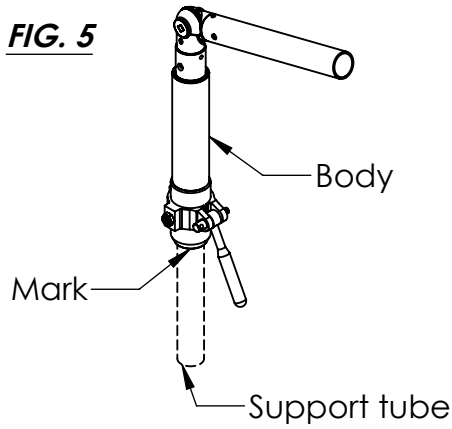

FIG. 4

4. Check - Drive pins should be pointing either directly outboard or directly inboard. Handle with elbow should rotate through a 90° arc, from straight back to straight out.

FIG. 5



5. Mark support tube and bottom of body once correct position Port/ Starboard is determined. DO NOT WELD AT THIS TIME.

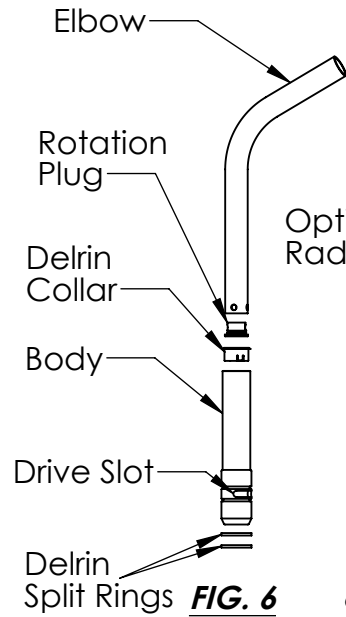

FIG. 6

6. Take assembled TOP GUNS apart.

- Slide elbow or Radial Joint Assembly out of body.
- Take off Delrin Collar and Delrin Split Rings.
- Remove large lock nut in handle and remove hinge bolt. See Fig 2A. Separate and remove clamp assembly from body

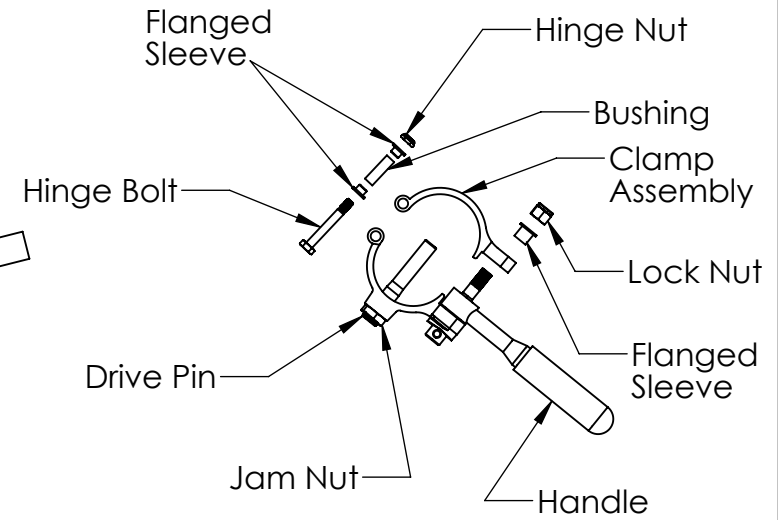
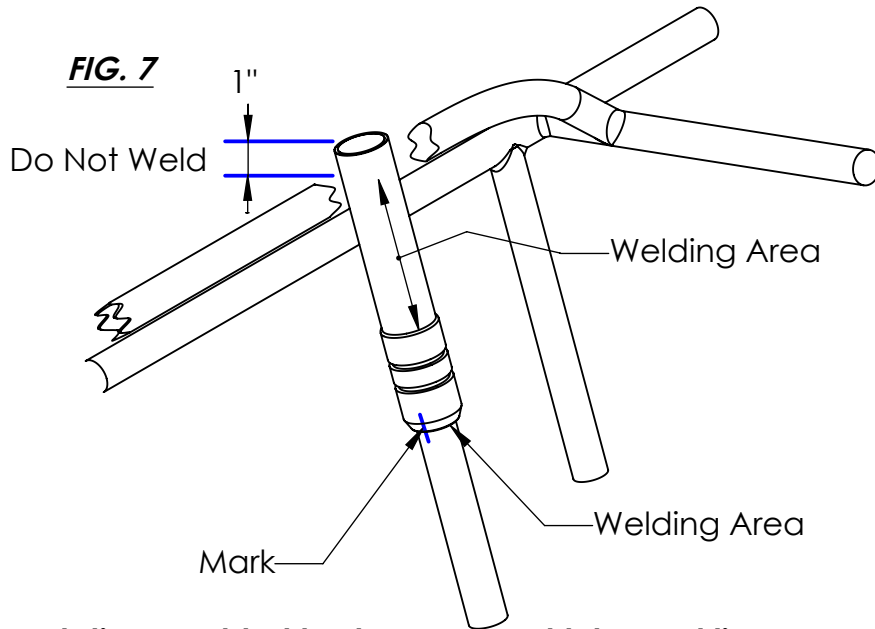
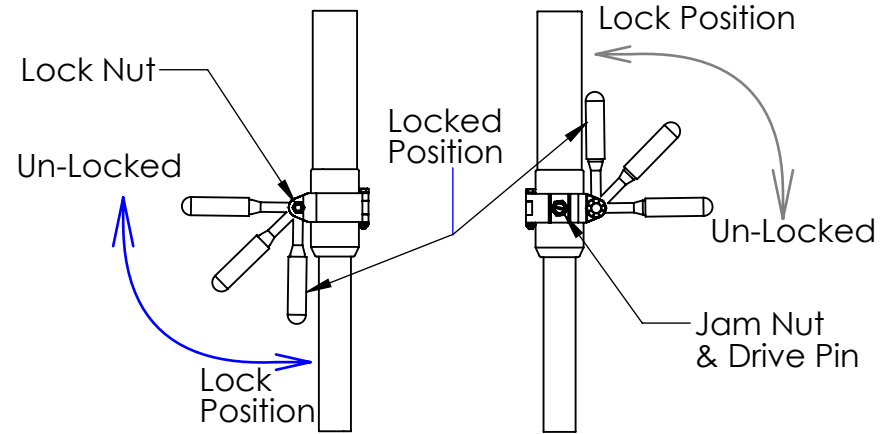

FIG. 7



7. Put disassembled body on support tube and line up marks and weld in position. Braces can be welded where indicated. Do not weld in area of clamp assembly or within 1" of top of main body.



8. Reassemble TOP GUN in reverse order. Be sure to line up hole in elbow or Radial Joint Assembly with drive pin when putting clamp assembly back. Tighten enough so handle locks TOP GUN in place. Adjust drive pin by tightening with a screw driver. Tighten jam nut to hold in position.

Final Prep: Drill 1/8" drain hole in lowest part of support tube see FIG 4